

PRESSURE-RATED PVC INTERNAL RESTRAINT FOR RIEBER GROOVE APPLICATIONS



- Potable
- Irrigation
- Reclaim
- Sewer Force Main

AWWA C900 & ASTM D2241 Available Pipe & Fitting Sizes (SBR or EPDM)									
	4"	6"	8"	10"	12"	16"	18"	20"	24"
CIOD	✓	✓	✓	✓	✓	✓	✓	✓	✓
IPS	✓	✓	✓						



STAINLESS LOCKING SEGMENTS

Locking segments engage progressively as load increases

RIEBERLOK GASKET

Proprietary seal tolerates dimensional variation of pipe bells and deflection

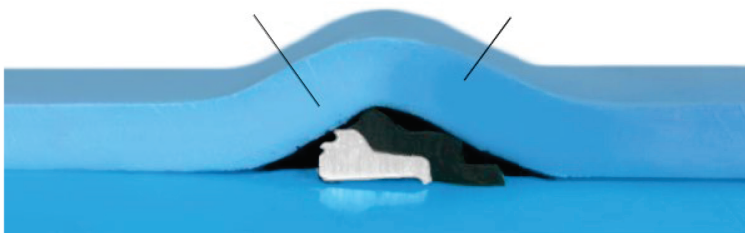

PRESSURE CLASS

CIOD AWWA-C900		IPS AWWA-C900	
305 psi	DR14	250 psi	SDR 17
235 psi	DR18	200 psi	SDR 21
165 psi	DR25	160 psi	SDR 26



- FM approved
- Available in SBR or EPDM
- Stainless steel locking segments
- Pre-installed at plant or field installed
- Works on all C900 pipe & PVC pressure fittings that use the rieber gasket
- Rated at the pipe pressure rating with a 2:1 safety factor
- Allows the full deflection of the pipe joint, as recommended by the pipe manufacturer
- Suitable for open trench, road bores and casing applications. Please contact RieberLok for HDD applications



WHICH ONE WOULD YOU RATHER INSTALL?



RIEBERLOK® GASKET

OR

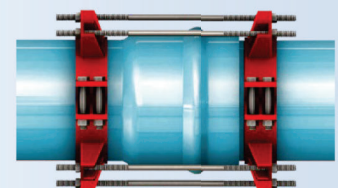

BOLT-ON HARNESS RESTRAINT

PRESSURE-RATED PVC INTERNAL RESTRAINT FOR RIEBER GROOVE APPLICATIONS



MAXIMUM PULL FORCE FOR HDD APPLICATIONS *CONTACT RIEBERLOK PRIOR TO HDD INSTALLATION*		
NOMINAL DIAMETER AWWAC900	MAXIMUM APPLIED PULLING FORCE (POUNDS)	
	CIOD-DR 18 CLASS 235	CIOD-DR 14 CLASS 305
4"	4,300	5,500
6"	8,800	11,000
8"	15,000	20,000
10"	23,000	30,000
12"	32,000	42,000
16"	55,000	72,000
18"	70,000	91,000
20"	86,000	111,000
24"	122,000	159,000
	IPS-SDR 26 CLASS 160	IPS-SDR 21 CLASS 200
4"	2,500	3,200
6"	5,500	6,900
8"	9,400	11,700

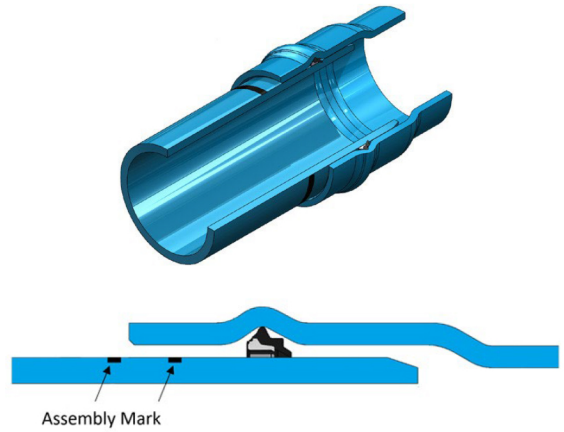

* RieberLok does not recommend applying pulling forces in excess of the pipe MFG's recommendations. Please contact RieberLok for additional pulling forces.

- RieberLok is FM approved (CIOD 4"–12")
- ASTM D3139 compliant
- FM1612
- Compliant with all rieber type sockets
- ASTM D395, D412, D471, D573, D883, D1149, D1229, D1349, D1414, D1415, D1566 and F913 compliant
- Assembly Instructions, Field Cut Instruction and HDD Guidelines are available at RieberLok.com

Remove	Remove the existing RieberLok gasket with a flat head screw driver.
Wipe	Thoroughly wipe and clean the gasket groove inside the pipe bell.
Place	Place an RieberLok gasket into the bell socket previously occupied by the rieber gasket, color coded face out.
Install	Assemble the pipe joint in the same manner as you would a standard application.

RieberLok Gasket Color Codes		
For Rieber Gasket Replacement:		
1) CIOD, SBR		White
2) CIOD, EPDM		Orange
3) IPS, SBR		Pink
4) IPS, EPDM		Green
For Anger Groove Applications:		
5) CIOD, SBR		Red
6) CIOD, EPDM		Yellow

For more information about the easiest and fastest C900 PVC pipe restraint product on the market, contact us today at sales@rieberlok.com or visit us online at www.rieberlok.com.

